



TRANSIT + COMMUNITY

Conference Guide

November 5–8, 2023

Sheraton Phoenix Downtown
Phoenix, Arizona





The Mpact Transit + Community conference is a celebration of transit-oriented communities.

What it takes to build them. The ingenuity and dedication of the many cross-sector stakeholders involved. And, the belief in the possibility that together we can build more just, sustainable and resilient communities with transit at the center.

It's hard work, no doubt! But that's why we come together. To recharge - and to share what's working in communities across North America.

Thank you for coming! Use your time at the conference to challenge your perceptions. Attend sessions and meet people that push you out of your comfort zone. Listening and learning across boundaries is where innovative ideas take shape.

Take time to explore the region. Walk around downtown Phoenix – or grab a bike or scooter to see Roosevelt Row, Margaret T. Hance Park and new residential neighborhoods downtown. Hop on a bus or the light rail to explore beyond downtown or into other cities across the region.

Dive into all that is offered at the conference.
Reshape your sense of what's possible.
Build your network for the year ahead.

Welcome!

Thank You Sponsors

The Mpact Transit + Community conference wouldn't be possible without our engaged and generous sponsors. Conference registration covers about half of overall expenses & sponsors help cover the rest.

Check the center spread for the 2023 sponsors!





Things to Know

- Badges are required at all plenaries, sessions, networking events, receptions, meals and breaks on- and off-site.
- Registration and check-in for Mobile Workshops and Pre-Conference Events are on the 3rd Level.
- Transit passes for the Valley Metro system are available for conference attendees. Thanks to Valley Metro, chair of the Local Host Committee. See the app or the Local Information table in the Public Square for more information.
- The Speaker Ready Room, for speakers and presenters to connect before their session or workshop, is South Mountain, 2nd Level.

Support the local LGBTQ+ Community

During the 2023 conference, Mpact is holding a fundraiser with **one-n-ten**, Arizona's largest organization providing comprehensive services to LGBTQ+ youth. Our goal is to raise \$1000. Find out about **one-n-ten** at the Mpact Innovators' Give Back event, the LGBTQ+ Welcome (both on Sunday) or by joining Monday's lunch time walking tour that stops

DONATE TO



by **one-n-ten**. Also see the conference mobile app for more about **one-n-ten**.



Be social!

Posting on your preferred social media platform is a great way to remember the things you learn, the people you meet or the places you see.

Tag the conference with
#mpactphx

and

@mpactmobility



Take a look at the stream on the social wall in the Public Square.

Sponsored by



DOWNTOWN MAP

McDowell/Central

Welcome Reception at Phoenix Art Museum
Sunday 6–9 pm (1625 North Central Ave)

LGBTQ+ Welcome at Fez
Sunday 4–6 pm (105 West Portland St)

Roosevelt/Central

**Mpact Transit
+ Community
Conference**
Nov 5–8
Sheraton Phoenix
Downtown
(340 North 3rd St)

**Mpact PK Slam
at Orpheum
Theatre**
Tues 8–10 pm
(2023 West
Adams St)

Van Buren

Washington/Central

Jefferson/1st St

3rd St/Washington

2nd Level

Meeting Rooms:

Ahwatukee
Encanto A
Encanto B
Estrella
Laveen
Maryvale A
Maryvale B

Speaker Ready Room
South Mountain

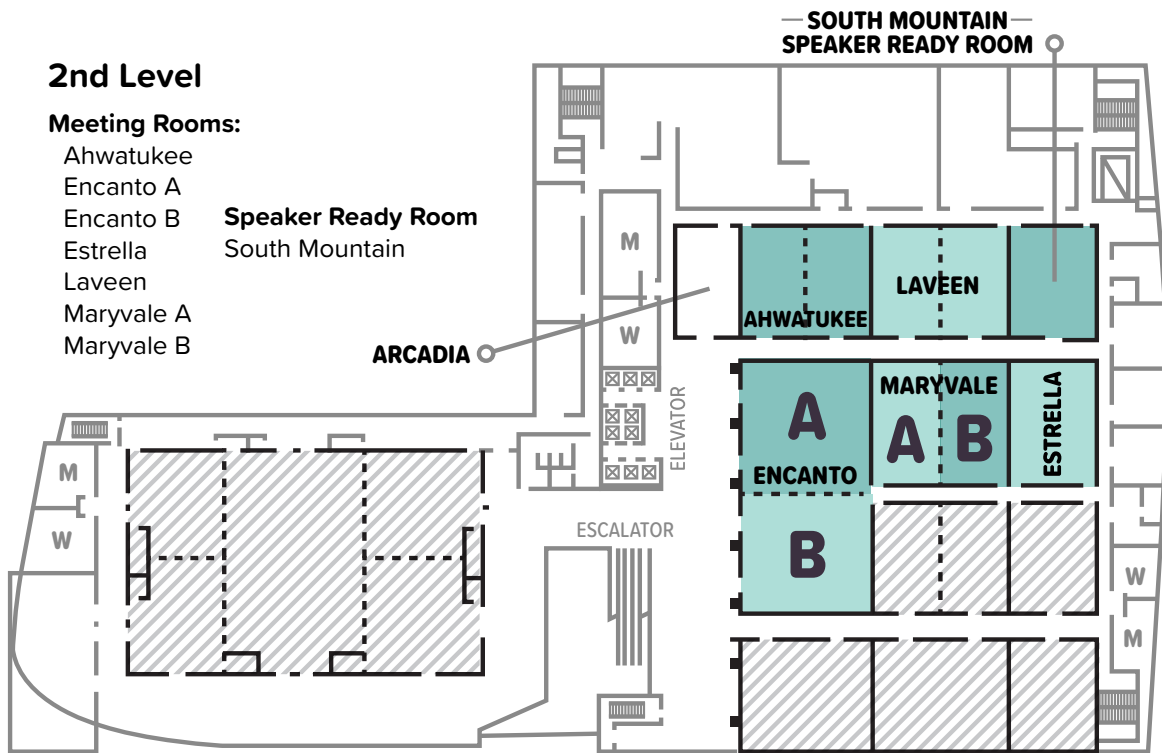

3rd Level

Public Square:

Registration
Local Information
Mobile Workshop Check-In
Mpact:LAB
Breakfast, Breaks and
Wind Down Reception

Plenaries:

Phoenix Ballroom

Meeting Rooms:

Cave Creek
Phoenix Ballroom C

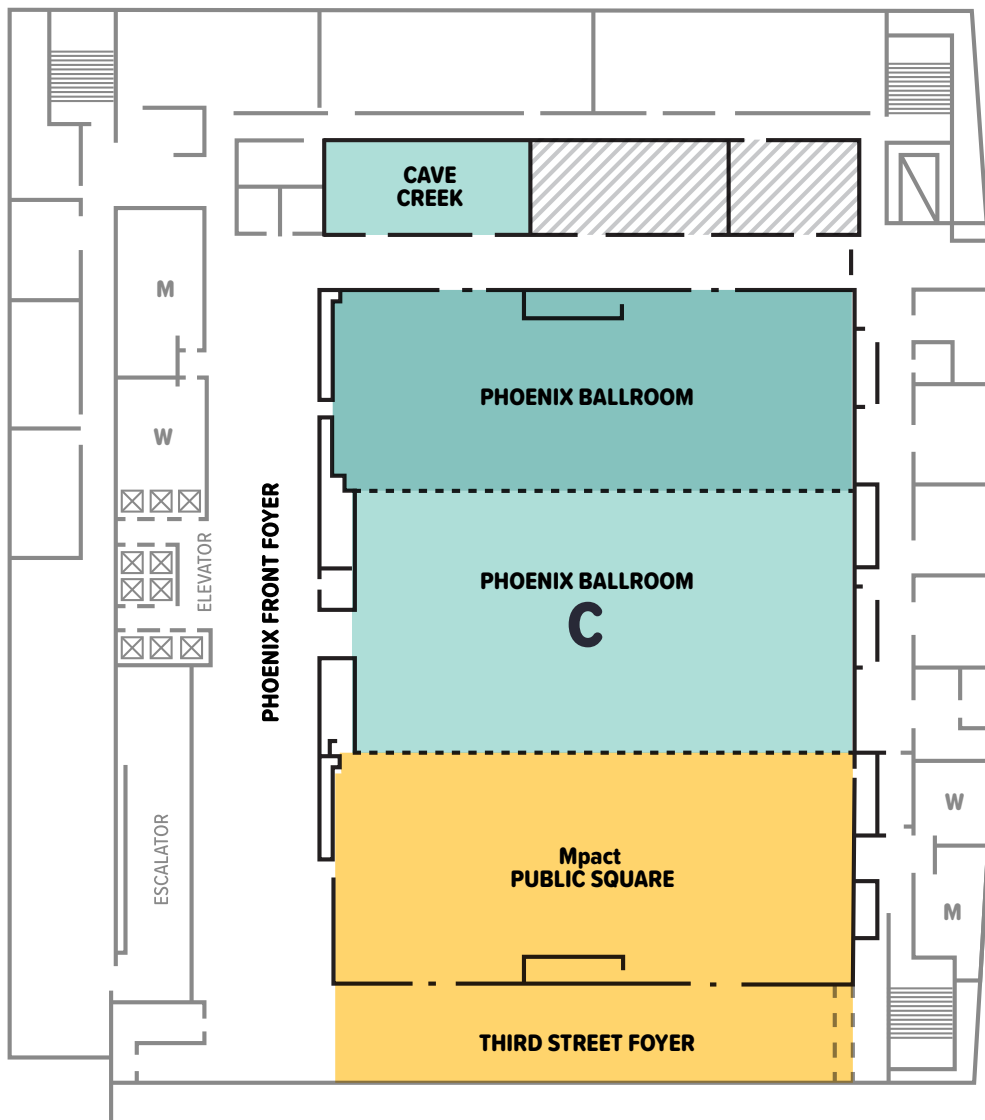

Take elevator to

4th Level

US DOT Office Hours

Hospitality Suites 432, 443, 444
(By appointment only. See details
in the mobile app.)

Quiet/Mother's/Prayer Room

Hospitality Suite 428
(Request key at Registration)

Valley Overlook Patio

Plenaries Take on the Big Topics!

These are the big discussions – *with everyone in the room!*

Opening Plenary

Sponsored by



Monday, November 6

8:00 am – 9:30 am AICP CM 1.5 Phoenix Ballroom, 3rd Level

PLENARY DISCUSSION:

Health in All Places

Walkable, transit-oriented communities are healthier. How can we make these communities a reality for more people?

Welcome

Darryl Slim,
Diné Wellness Educator,
Mesa, AZ

Jessica Mefford-Miller,
Chief Executive Officer, Valley
Metro, Phoenix, AZ

Jason Foster, President and Chief Operating Officer, Destination Crenshaw, Los Angeles, CA

Debarati “Mimi” Majumdar Narayan, Officer, Health Programs, The Pew Charitable Trusts, Washington, DC

John Vu, Vice President of Strategy for Community Health, Kaiser Permanente, Berkeley, CA

Moderator: Jon Ford, Senior Regional Field Manager, Community Development, Federal Reserve Bank of San Francisco, San Francisco, CA



Ideas transform communities

At HDR, we're helping clients push open the doors to what's possible, every day.

Proud sponsor of Mpace.



Tuesday Plenary

Sponsored by



Tuesday, **November 7**

8:00 am – 9:30 am

AICP CM 1.5 Eq 1 Phoenix Ballroom, 3rd Level

PLENARY DISCUSSION:

A Decade of ETOD: The Story and the Playbook

During the past decade, the “ETOD” movement - embedding Equity into traditional Transit-Oriented Development - has moved from aspiration to practice. It now has a storybook of projects launched and a playbook drawn from successful work in a range of cities.

Welcome

Earl Blumenauer,
Congressman, 3rd District, Oregon

Amari Foster, Interim Managing Director,
TransFormation Alliance, Atlanta, GA

Jacky Grimshaw, Vice President, Government
Affairs, Center for Neighborhood Technology,
Chicago, IL

Laura Raymond, Director, Alliance for Community
Transit-Los Angeles (ACT-LA), Los Angeles, CA

Roberto Requejo, Executive Director, Elevated
Chicago, Chicago, IL

Moderator: Mariia Zimmerman, AICP, Strategic
Advisor for Technical Assistance and Community
Solutions, Office of the Secretary, U.S. Department
of Transportation, Washington, DC

Closing Plenary Lunch

Sponsored by



Wednesday, **November 8**

11:30 am – 1:30 pm

AICP CM 1.5 Phoenix Ballroom, 3rd Level

PLENARY DISCUSSION:

Downtown and Not Downtown: The Evolving Recipe for Resilient Places

Why are some downtowns bouncing back more than others? What neighborhoods or places, downtown or not, are thriving – and why?

Welcome

Christopher Coes,
Assistant Secretary for Transportation Policy,
USDOT, Washington, DC

Karen Chapple, Ph.D., Director, School of Cities,
University of Toronto, Toronto ON

Nichol Bourdeaux, Chief Planning and Engagement
Officer, Utah Transit Authority, Salt Lake City, UT

Dee Brewer, Executive Director, Downtown Alliance
of Salt Lake City, Salt Lake City, UT

Ryan Johnson, CEO, Culdesac, Tempe, AZ

Emeka Moneme, President, Capitol Riverfront,
Washington, DC

Moderator: Christopher Coes, Assistant Secretary
for Transportation Policy, USDOT, Washington, DC

Mpact Public Square

The Public Square is the central gathering place for the conference. Located on the 3rd Level, it's where you'll come for breakfast, breaks and to see all our exhibitors have to offer.

Registration. Open daily. Ask about adding ticketed events to your schedule, including Mobile Workshops, Pre-Conference Events, the Masterclass Academy and Regional Day. Each of these requires a separate fee. The Masterclass Academy and Regional Day are open to people not registered for the conference.

Mobile Workshop Check-In. Please check in 10-15 minutes before your workshop. And please remember to return your headsets when you get back!

Bookstore. Open Monday and Tuesday, with books about the region and about building great places to live.

Mpact:LAB. New this year! Stop by for the question of the day and to find out about regional capacity building and leadership development. **Sponsored by AARP**

Local Information. Say hello to the Local Host Committee. Get answers to your questions about the region, details about the Valley Metro transit system and ideas for lunch.

Monday Wind-Down. It's a party to end the first full day. Swap stories about the sessions you attended. Tour all the exhibits. Appetizers and cash bar.

Sponsored by VIX

Social Wall. See what people are saying on social.

Sponsored by mesa·az

Charging Stations and Wi-Fi Hot Spot.

Charge Up and Log on!

Network: mpact Password: transitplus



Exhibitors

*Make sure to meet them all!
Exhibits are open Monday
and Tuesday.*

BROOKVILLE

EPIC METALS®

SIEMENS

**SPATIAL
MEDIA**

WTS Advancing women
Advancing transportation

ARDURRA

Culdesac™

AzTA
ARIZONA TRANSIT ASSOCIATION



Making tracks toward a sustainable future.

Public transportation systems have long connected communities and stimulated economic development. And decarbonizing the transportation sector will change how we have been moving goods and people for more than a century. At Jacobs, we are up to the challenge. In fact, we see it as an opportunity to keep future generations moving forward.

We tackle the world's toughest challenges.

Follow us @JacobsConnects | [jacobs.com](https://www.jacobs.com)



Jacobs

Challenging today.
Reinventing tomorrow.



Connecting Communities

We're proud to sponsor the
2023 Mptact Transit + Community Conference

Delivering a better world

AECOM

 [aecom.com](https://www.aecom.com)

DAILY SCHEDULE

Sunday, November 5

7:00 am – 6:00 pm

Registration and Mobile Workshop Check-In
Public Square, 3rd Level

Pre-Conference Events

Pre-registration required.

Check in 15 minutes before your tour at the
Mobile Workshop desk, Public Square, 3rd Level

7:30 am – 2:00 pm

**Arcosanti: An Experimental
Prototype Arcology**
\$85 includes lunch

1:00 pm – 5:00 pm

**Light Rail with a Twist:
Take the Challenge**
\$85 includes appetizers

Mobile Workshops

Pre-registration required.

Check in 15 minutes before your workshop at the
Mobile Workshop desk, Public Square, 3rd Level

7:30 am – 4:30 pm

MW01 **Tucson's Sun
Link Modern Streetcar:
Development with Local Flavor**
\$85 includes lunch
Bus, Streetcar, Walking **AICP CM 4.5**

9:00 am – 12:00 pm

MW02 **Downtown Tempe:
Walk the State Highway,
Paddle the Dry River Bed**
\$65
Kayaking, Walking **AICP CM 2**

9:45 am – 1:15 pm

MW03 **Car-Free Arizona:
Achieving Sustainable
Dreams at Culdesac**
\$65 includes lunch
Walking, Bus **AICP CM 3**

Sunday Session

2:00 pm – 4:00 pm

**Partnering with the US
Department of Transportation**
AICP CM 2
Encanto A, 2nd Level

Networking

2:00 pm – 4:00 pm

**Mpact Innovators Presents:
Giving Back to the LGBTQ+
Community in Phoenix**
Meet in Lobby

4:00 pm – 6:00 pm

**LGBTQ+ Community
& Friends: Welcome
Fez**
105 West Portland Street
Phoenix

Masterclass Academy from Mpact:LAB

12:30 pm – 5:30 pm **\$189 open to the public**

In today's ever-changing world, cross-sector, interdisciplinary, collaborative work requires its own set of skills. Join us for a day of workshops to build your capacity to be an effective team member and leader.

Sponsored by



Each registrant will choose 1 class per time slot.

12:30 pm – 2:00 pm

How to Make a Winning Presentation
Maryvale A, 2nd Level

An Ecosystem Approach to Systems Change
Maryvale B, 2nd Level

2:15 pm – 3:45 pm

Harnessing the Power of Storytelling
Maryvale A, 2nd Level

The End of Hustle Culture: How to Quit Being Busy and Start Making a Difference
Maryvale B, 2nd Level

4:00 pm - 5:30 pm

Deciding How to Decide: Learning from Adaptive Leaders Maryvale A, 2nd Level

Your Impact is Everything: How to Sell the Difference You're Making
Maryvale B, 2nd Level

Welcome Reception

6:00 pm – 9:00 pm

Say hello to old friends and meet new ones at this indoor-outdoor party under the Phoenix sky. A welcome drink for everyone and eats featuring fresh, local flavors!

Getting there: Walk (1.3 miles) just north from the Sheraton past Margaret T. Hance Park. Or take light rail from Van Buren/Central Avenue Station: catch the 19th Ave/Dunlap train, go 2 stops to McDowell/Central Avenue, then walk half a block to the Museum.

Phoenix Art Museum,
1625 N Central Ave,
Phoenix



DAILY SCHEDULE

Monday, November 6

7:00 am – 8:00 am

Continental Breakfast Sponsored by
Public Square, 3rd Level



7:00 am – 6:00 pm

Registration and Public Square Open

Breakfast and Breaks
Exhibits
Mobile Workshop Check-In
Local Information
Bookstore
Mpact:LAB Sponsored by



Visit Phoenix

Opening Plenary

Sponsored by

8:00 am – 9:30 am

Health in All Places

AICP CM 1.5 Phoenix Ballroom, 3rd Level



9:30 am – 10:00 am

Public Square, 3rd Level

Refreshment Break Sponsored by



Monday Morning Mobile Workshops

Check in 15 minutes before your workshop at the
Mobile Workshop desk, Public Square, 3rd Level

9:30 am – 12:30 pm

MW04 **Grand Canal
Multi-Use Trail**

\$65

Bicycling AICP CM 2.5

9:30 am – 12:30 pm

MW05 **Phoenix Streets:
Historical Streetcar to
Shared Mobility**

\$45

Walking AICP CM 1

9:45 am – 1:15 pm

MW06 **Car-Free Arizona:
Achieving Sustainable
Dreams at Culdesac**

\$65 includes lunch

Bus, Walking AICP CM 3

10:00 am – 1:00 pm

MW07 **Take a “Transit Walk”
at the Mobility Center**

\$65 includes lunch

Light Rail, Walking AICP CM 1.5

10:30 am – 1:30 pm

MW08 **Cultivating Community:
Urban Gardens on the LRT**

\$65 includes lunch

Light Rail, Walking AICP CM 1.5 Eq 1 SR 1



DOT Office Hours

Hospitality Suites
432, 443 & 444, 4th Level

By appointment only.
See the app for details.

Monday Morning Sessions

10:00 am – 11:30 am

TOD to TOC:

From the Ground Up

AICP CM 1.5

Cave Creek, 3rd Level

A Coalition Approach to Equitable Transit

AICP CM 1.5 Eq 1

Maryvale A, 2nd Level

Ice and Fire:

Landscapes for Climate
Resilience

AICP CM 1.5 SR 1

Maryvale B, 2nd Level

Lasso that Money!:

The Basics of Funding

AICP CM 1.5

Laveen, 2nd Level

Form or Finance: Making the Missing Middle Work

AICP CM 1.5

Encanto B, 2nd Level

Driven by Data:

Unleashing the Potential
of Rail Corridors

AICP CM 1.5

Estrella, 2nd Level

Transit Agency CEOs:

Circling Back and
Looking Forward

AICP CM 1.5

Encanto A, 2nd Level

Reimagining Arterials: The Next Big Thing in TOD

AICP CM 1.5

Ahwatukee, 2nd Level

*For descriptions
and speakers,
check the App!*

Downtime: Lunch on Your Own

11:30 am – 1:30 pm

This is your chance to visit the exhibits in the Public Square. Then, get outside and explore the area – on foot, bike or scooter or via bus or light rail. Check the mobile app for lunch options. Or ask at Local Information in the Public Square about lunch, places to see and transit options.

Networking

MPACT INNOVATORS PRESENTS:

Walking Tours

Sponsored by



11:30 am – 1:30 pm

Meet in the lobby. Look for the sign for the tour you'd like to join. Limit 25 per tour. Each group will stop for lunch along the way.

**Walking Tour: From one-n-ten
to Margaret T. Hance Park**

**Walking Tour: Phoenix on Foot:
Exploring Urban Transformation
Through the Taylor Paseo District**



Phoenix 2023 #mpactphx

Diamond

AECOM

HDR

HNTB

Jacobs

NTI
National Transit Institute

WSP

Platinum

Stacy and Witbeck

Gold

VIX

AARP



Kiewit



**GANNETT
FLEMING**

Silver



City of Phoenix
PUBLIC TRANSIT DEPARTMENT

HILL
International



ARDURRA

mesa·az



Tempe



SRP
Delivering water and power®

Kimley»Horn

Expect More. Experience Better.

Thank you Sponsors

We are very grateful to all our sponsors for stepping up to support the 2023 Mpact Transit + Community conference – and the movement to build stronger, more just and resilient communities around transit.

*Please join us in
thanking them!*



Valley Metro

Bronze



ZYSCOVICH

Livability



Phoenix 2023 #mpactphx

DAILY SCHEDULE

Monday, **November 6**

Monday Afternoon Mobile Workshops

Check in 15 minutes before your workshop at the
Mobile Workshop desk, Public Square, 3rd Level

1:00 pm – 3:00 pm

MW09 **Central Station
Phoenix Redevelopment:
A Hard Hat View**

\$45
Walking **AICP CM 1.5**

1:00 pm – 4:00 pm

MW10 **Extension to the
Future: From 70s Mall to
Walkable Urban Village**

\$45
Walking, Bus **AICP CM 2.5**

1:30 pm – 5:30 pm

MW11 **The View from “A”
Mountain: How Downtown
Tempe Embraced Nature**

\$65
Walking, Bus **AICP CM 1.5 SR 1**

2:00 pm – 5:00 pm

MW12 **Sky Train: Automation and the
Airport Experience**

\$45
Walking, Bus **AICP CM 3**

Sponsored by
Kimley»Horn
Expect More. Experience Better.

2:00 pm – 5:00 pm

MW13 **Discover Vibrant
Tempe Via Modern Streetcar**

\$45
Light Rail, Walking, Streetcar **AICP CM 1**

HNTB

The HNTB Companies:
Architecture, Planning, Engineering, Construction Management

hntb.com

Mipact Champion

Making Connections Possible

QR Code

Monday Early Afternoon Sessions

1:30 pm – 3:00 pm

BRT 101: What You Need to Know Before You Start

AICP CM 1.5 Eq 1
Encanto A, 2nd Level

Transit Stops: Unlocking the Potential

AICP CM 1.5 Eq 1
Ahwatukee, 2nd Level

TOD Guidelines: What's Working Best

AICP CM 1.5
Cave Creek, 3rd Level

Making the Case for Transit from an Economic Development Lens

AICP CM 1.5
Phoenix Ballroom C, 3rd Level

Supercharging Your Bus Network

AICP CM 1.5
Laveen, 2nd Level

Red Line Aftermath: How Baltimore Turned Cancellation Into Innovation

AICP CM 1.5
Maryvale A, 2nd Level

The Power of Partnership to Address Homelessness

AICP CM 1.5
Encanto B, 2nd Level

Is the Sky Falling? A Peer Discussion on Climate Disruption

AICP CM 1.5 SR 1
Maryvale B, 2nd Level

3:00 pm – 3:30 pm

Refreshment Break
Public Square, 3rd Level

Sponsored by
PARSONS

3:15 pm – 6:00 pm

Politics of Place: Stories of Land and Housing in Phoenix

Meet in lobby.
Pre-registration required.

\$65
Bus, Walking AICP CM 2.5 Eq 1

Monday Late Afternoon Sessions

3:30 pm – 5:00 pm

What's Up (or Down) with Fare Policy?

AICP CM 1.5
Encanto B, 2nd Level

The Mandates & Mayhem Around Housing Reform

AICP CM 1.5
Ahwatukee, 2nd Level

Community Ownership as an Anti-Displacement Strategy

AICP CM 1.5 Eq 1
Phoenix Ballroom C, 3rd Level

Corridor Planning for TOD: Why is it Different?

AICP CM 1.5 Eq 1
Maryvale A, 2nd Level

Growing Ridership in a Post-Pandemic Era

AICP CM 1.5
Encanto A, 2nd Level

The ZEV Opportunity:

Equitable Pathways to Zero-Emission Deployments
AICP CM 1.5 Eq 1 SR 1
Cave Creek, 3rd Level

Complete Streets 2.0

AICP CM 1.5
Maryvale B, 2nd Level

TOD Dollars and Sense for Today's Market

AICP CM 1.5
Laveen, 2nd Level

Monday Wind Down

5:00 pm – 6:30 pm

Exhibitor Reception in the Public Square

Sponsored by



Celebrate the first full day of the conference! Compare notes about the sessions or Mobile Workshops you attended. Revive the conversation from the opening plenary. Stop by the exhibit booths as you walk and talk. Appetizers and cash bar.

DAILY SCHEDULE

Tuesday, **November 7**

Networking

7:00 am – 7:30 am

Mpact Innovators Presents:
Fast Charge: Breath Work and Chair Yoga
Valley Overlook, 4th Level

7:00 am – 8:00 am

Continental Breakfast Sponsored by
Public Square, 3rd Level 

7:00 am – 4:00 pm Public Square, 3rd Level

Registration and Public Square Open

Breakfast and Breaks
Exhibits
Mobile Workshop Check-In
Local Information
Bookstore
Mpact:LAB Sponsored by



DOT Office Hours

Hospitality Suites
432, 443 & 444, 4th Level
By appointment only.
See the app for details.

Tuesday Plenary

8:00 am – 9:30 am

**A Decade of ETOD:
The Story and
the Playbook** Sponsored by

AICP CM 1.5 Eq 1
Phoenix Ballroom, 3rd Level

9:30 am – 10:00 am

Refreshment Break Sponsored by
Public Square, 3rd Level



Proud
builders
of public
transit
since 1981.

**Stacy and
Witbeck**
stacywitbeck.com

Tuesday Morning Mobile Workshops

Check in 15 minutes before your workshop at the Mobile Workshop desk, Public Square, 3rd Level

9:30 am – 12:30 pm

MW14 **Grand Canal Multi-Use Trail**

\$65

Bicycling **AICP CM 2.5**

9:45 am – 12:30 pm

MW15 **The Asian District: Along the Light Rail in Mesa**

\$65

Light Rail, Walking, Bus **AICP CM 1.5**

10:00 am – 2:00 pm

MW16 **Bringing LRT to South Phoenix: Design, Construction, Community**

\$65 includes lunch

Walking, Bus **AICP CM 4 Eq 1**

Tuesday Morning Sessions

10:00 am – 11:30 am

How Transit is Responding to Security Challenges

AICP CM 1.5

Encanto A, 2nd Level

Humanizing Highways: Wait ... What?

AICP CM 1.5

Maryvale B, 2nd Level

Transit Agencies and MPOs: Stepping Up to Lead TODs

AICP CM 1.5

Laveen, 2nd Level

Streetcar: Living the Dream

AICP CM 1.5

Maryvale A, 2nd Level

TOD Practitioners' Forum

AICP CM 1.5

Ahwatukee, 2nd Level

Microgrids: More Than Powering Buses

AICP CM 1.5 SR 1

Encanto B

Pivoting to Plan B in Austin

AICP CM 1.5

Cave Creek, 3rd Level

Downtime: Lunch on Your Own

11:30 am – 1:30 pm

This is your chance to stop by exhibits in the Public Square then get outside and explore the area – on foot, bike or scooter or via bus or light rail. Check the mobile app for lunch options. Or ask at Local Information in the Public Square about lunch, places to see and transit options.

Networking

11:30 am – 1:30 pm

MPACT INNOVATORS PRESENTS:

Walking Tours

Meet in the lobby. Look for the sign for the tour you'd like to join. Limit 25 per tour. Each group will stop for lunch along the way.

**Walking Tour
Rail Extensions &
the Downtown Hub**

**Walking Tour
Arizona Center &
Heritage Square**

DAILY SCHEDULE

Tuesday, November 7

Tuesday Afternoon Mobile Workshops

Check in 15 minutes before your workshop at the
Mobile Workshop desk, Public Square, 3rd Level

1:00 pm – 5:30 pm

MW17 **Tour de Core!**
Infill along Light Rail
in Downtown Phoenix
\$65
Light Rail, Walking **AICP CM 3**

1:00 pm – 4:30 pm

MW18 **Tracks through Time:**
Uncovering Hohokam Culture
\$45
Light Rail, Walking **AICP CM 1.75**

1:30 pm – 4:30 pm

MW19 **Arts Pave the Way:**
Roosevelt Row
\$45
Walking, Light Rail **AICP CM 2.75**

2:00 pm – 5:00 pm

MW20 **Main Street Mesa: New**
Development, Historic Character
\$65
Bus, Light Rail, Walking **AICP CM 1.5**

2:00 pm – 5:00 pm

MW21 **Inside the Operation**
and Maintenance Center
\$45
Light Rail, Walking **AICP CM 2**

Tuesday Early Afternoon Sessions

1:30 pm – 3:00 pm

Parking from
All Angles
AICP CM 1.5
Encanto A, 2nd Level

Cross-sector Partnerships
for Affordable Housing
AICP CM 1.5
Cave Creek, 3rd Level

#OptOutside: Transit and
Recreational Access
AICP CM 1.5 SR 1
Laveen, 2nd Level

Station Design and Wayfinding:
Enhancing the Customer Experience
AICP CM 1.5 Eq 1
Maryvale A, 2nd Level

Capping Projects Through
Time: Lessons Learned
AICP CM 1.5 Eq 1
Maryvale B, 2nd Level

Economic and Workforce
Development: Equity and
Cultural Competence
AICP CM 1.5 Eq 1
Encanto B, 2nd Level

Investment in People:
Rail Supportive Community
Development
AICP CM 1.5 Eq 1
Ahwatukee A&B, 2nd Level

The Never Ending
Importance of a
Story Told Well
AICP CM 1.5
Phoenix Ballroom C,
3rd Level

3:00 pm – 3:30 pm

Refreshment Break, Public Square, 3rd Level

Sponsored by



SUNDT

Tuesday Late Afternoon Sessions

3:30 pm – 5:00 pm

Microtransit: Transit Savior or Political Stopgap?AICP CM 1.5 Eq 1
Maryvale A, 2nd Level**Bus Network Redesign: A Changing Landscape**AICP CM 1.5
Laveen, 2nd Level**Equitable Decision-Making: From Ambition to Action**AICP CM 1.5 Eq 1
Encanto A, 2nd Level**Pushing the Joint Development Envelope: Jurisdictional Partnerships**AICP CM 1.5
Phoenix Ballroom C, 3rd Level**Community Engagement 201: The Practical Application of Capacity Building**AICP CM 1.5 Eq 1
Encanto B, 2nd Level**Getting to Transit: Expanding Last-mile Access Building**AICP CM 1.5 Eq 1 SR 1
Maryvale B, 2nd Level**Mpact Innovators Presents: Idea Exchange - AI for Planners**AICP CM 1.5
Ahwatukee, 2nd Level

Networking

8:00 pm – 10:00 pm

Mpact Innovators Presents: The Mpact PK Slam

Orpheum Theater, 203 W Adams St, Phoenix

Creative, candid, energetic! The PK Slam features stand-up presentations in the style of PechaKucha™. A Tuesday night tradition – the one everybody talks about! Cash bar.

Getting there: Walk (0.6 mi) three blocks west and three blocks south of the hotel to Adams Street.

Sponsored by

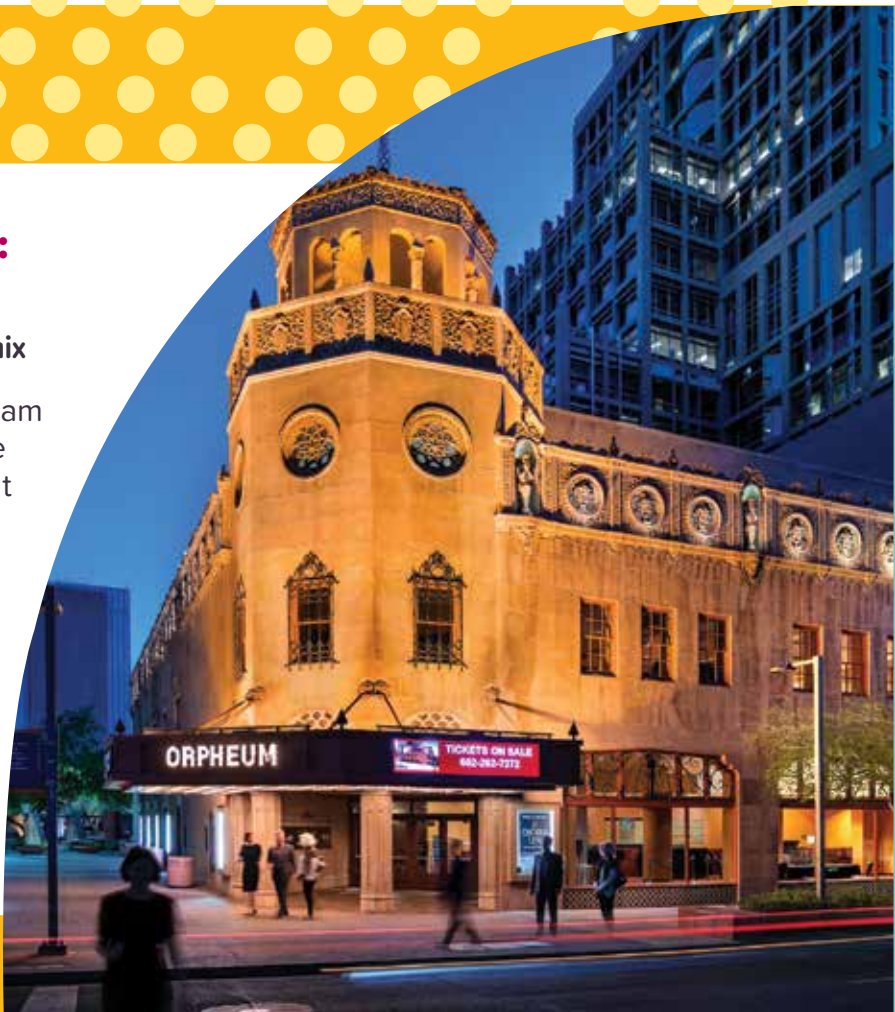

DAILY SCHEDULE

Wednesday, November 8

Networking

7:00 am – 7:30 am

Mpact Innovators Presents: PK Slam Recovery Run
Meet in Lobby

8:00 am – 12:00 pm

Public Square, 3rd Level

Registration and Public Square Open

Breakfast and Breaks
Mobile Workshop Check-In
Local Information

8:00 am – 9:30 am

Sponsored by

Continental Breakfast
Public Square, 3rd Level



DOT Office Hours

Hospitality Suites
432, 443 & 444, 4th Level
By appointment only.
See the app for details.

Wednesday Mobile Workshops

Check in 15 minutes
before your workshop
at the Mobile Workshop
desk, Public Square,
3rd Level

8:30 am – 11:30 am

MW22 **50th Street Station:
Innovating for Accessibility**
\$45
Light Rail, Walking AICP CM 3 Eq 1

9:00 am – 11:00 am

MW23 **Evolving Downtown
Phoenix: Business District
to Neighborhood**
\$45
Walking AICP CM 1.5

Wednesday Lightning Sessions



FTA TOD Planning Grant:
Roundtable Discussion
AICP CM .75
Maryvale A, 2nd Level

**Infrastructure Projects
and Tribal Lands**
AICP CM .75
Cave Creek, 3rd Level

Mobility Hubs:
Hype or Substance?
AICP CM .75
Ahwatukee, 2nd Level

Housing Hard-Core:
Creative Investments in
Transit-Centric Affordability
AICP CM .75
Laveen, 2nd Level

Data Traveler:
Worldwide Lessons
in Expanding Transit
AICP CM .75
Maryvale B, 2nd Level

**True Accessibility and
Universal Design**
AICP CM .75
Estrella, 2nd Level

Wednesday Morning Sessions

10:00 am – 11:30 am

Big Data So What? Let's Get Somewhere

AICP CM 1.5
Estrella, 2nd Level

Navigating Transit's Fiscal Cliff

AICP CM 1.5
Maryvale B, 2nd Level

Flex Your BRT Muscles to Boost Your Corridor

AICP CM 1.5
Laveen, 2nd Level

ETOD: Centering Community Vision and Power

AICP CM 1.5 Eq 1
Ahwatukee, 2nd Level

Doing It for the Neighborhood: Community-Centered Economic Inclusion

AICP CM 1.5 Eq 1
Cave Creek, 3rd Level

Transit + Mega Events: A Winning Team

AICP CM 1.5
Maryvale A, 2nd Level

Closing Plenary Lunch

11:30 am – 1:30 am

Sponsored by

AECOM

Downtown and Not Downtown: The Evolving Recipe for Resilient Places

Phoenix Ballroom, 3rd Level AICP CM 1.5



Scholarships

Conference scholarships help ensure that the network of attendees is diverse and includes community leaders without budgets for travel. Scholarship funds come from Mpact and sponsors including Hill International, GHD and Kimley Horn. *Thank you!*



Kimley»Horn
Expect More. Experience Better.



HILL
International

DAILY SCHEDULE

Wednesday, November 8

Regional Day

Wednesday, November 8 Encanto A&B, 2nd Level AICP CM 2.5

Forum
2:00 pm – 4:30 pm**Networking**
4:30 pm – 5:30 pm**\$25 open to
the public**

Continuing Our MOMENTUM

Regional Day is an opportunity for local stakeholders to delve into issues that specifically affect them.

Metro Phoenix is diverse and growing, with some of the most unique, environmentally and culturally sensitive geography in the country. Over the last four decades, a deliberative, consensus-based approach to planning and development has yielded robust investment in infrastructure.

But now the region is at a crossroads.

Taking MOMENTUM, the long-range regional plan, as a starting point, Regional Day will consider: How do we tell our story, articulate our past, fashion our future and build on the momentum that brought us this far?

The Regional Day program includes keynote speakers, a panel discussion and breakouts on key topics, plus a networking reception. See all the details on the mobile app or at mpactmobility.org/schedule.





Sponsored by



Here are ways we're working to make the conference generate less waste and be more sustainable.

- Compostable badges. And compostable plates, napkins and cups at the Welcome Reception and PK Slam.
- Water dispensers and glasses in meeting rooms and at breaks - fewer plastic water bottles in the trash!
- The leftover food from Mpace events is donated to local food banks.
- Conference signs are printed on 100% recyclable substrates.
- The conference hotel has a number of sustainable features, from low-flow water fixtures to use of Green-Seal certified cleaning products, from solar louvers on the south side of the building to a rooftop seasonal herb garden.

Big picture:

we're all working to build places to live, work and play that are connected by transit, walking, biking or sharing. Transit-friendly neighborhoods generate much lower emissions: the average trip length is 4.4 miles versus 9.1 miles in non-walkable, auto-oriented communities. Denser, more climate-friendly neighborhoods also create huge infrastructure efficiencies. It's four times cheaper to connect broadband networks, while stormwater runoff (a critical climate challenge) is 74% lower in walkable neighborhoods.

Question the existing
Imagine the impossible
Create the enduring



WSP USA partners with clients nationwide to create livable and vibrant communities that integrate reliable transit in a sustainable and equitable manner.

Find out what we can do for you.



wsp.com

Join our team! 

Hats off to the Local Host Committee!

The local host committee plays a huge role in the conference. They help tell the story of transit, mobility and development in the region, introducing us to projects and places across the Valley and beyond. They organize key elements of the conference: the welcome party on Sunday, pre-conference events, mobile workshops and Wednesday's Regional Day program. They also organize volunteers.

Valley Metro, the chair of the Local Host Committee, very kindly provides transit passes to conference attendees.

Stop by the Local Information table in the Public Square to meet our local hosts. Get answers to your questions about the region. And say thanks!

Jessica Mefford-Miller, CEO, Valley Metro
Carol Ketcherside, Local Host Chair, Valley Metro
Bree Boehlke, Valley Metro
Chris Bridges, City of Goodyear
Markus Coleman, City of Phoenix
Caitlin Eberle, Valley Metro
Hillary Foose, Valley Metro
Eric Iwersen, City of Tempe
Kevin Link, City of Glendale
Becky Miller, Arizona Transit Association
Lisa Muller, Valley Metro
Mark McLaren, HDR
Jessica Parks, WSP
Ryan Shelton, HDR
Jodi Sorrell, City of Mesa
Alexis Tameron-Kinsey, Valley Metro
Susan Tierney, Valley Metro
April Trevett, Valley Metro



Get to know the Valley of the Sun



This map is on the app. Zoom and pan to explore the region – and maybe plan a route on bike or transit!

Courtesy Maricopa Association of Governments.

Mpact Transit + Community Conference



Mpact Innovators

The Mpact Innovators are a national networking group formed to make the conference accessible, engaging, and meaningful for emerging professionals and those new to transit, mobility and development.

Mpact Innovators Presents:

- Saturday Night Welcome
- Sunday Give Back Event
- Monday and Tuesday Lunchtime Walking Tours
- Tuesday Morning Fast Charge
- Tuesday Idea Exchange – AI for Planners
- Tuesday night PK Slam, powered by PechaKucha™
- Wednesday morning PK Slam
- Recovery Run

Thanks to the Mpact Innovators working group and Mpact Innovators Chair, Shantelle Dreamer, Sustainable Transportation Planner, WSP USA, Boulder, CO

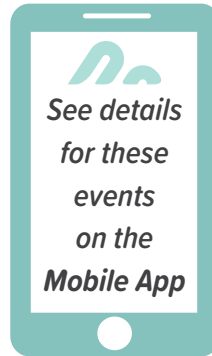

Interested in joining the Mpact Innovators?

Attend Mpact Innovator Events and talk to Shantelle Dreamer or incoming chair Corrie Parrish, Senior Planner, Kittleson & Associates, Portland, OR.

MOVE Roundtables

In this capacity-building program, local stakeholders examine a key question through the lenses of **Mobility, Opportunity, Voice and Equity**, creating momentum in a collaborative and unified direction.

We've held MOVE Roundtables in these locations: Buffalo, Cleveland, Indianapolis, Miami, Milwaukee, Phoenix, San Antonio, St. Louis, & Youngstown. Add yours!

Learn more at
Mpact:LAB in the Public Square



mpactmobility.org/lab



Mpact Partners

Mpact Partners are the heart of our network, bringing vast experience and expertise.

They share our commitment to working with communities to shape transit, mobility and development investments. Our National Steering Committee, made up of staff from Partner organizations, plays an essential role in the conference, curating all the sessions and speakers. They also are valued advisors about other Mpact programs. We also are grateful to Mpact Partners for financially supporting our work.



AECOM

American Public Transportation Association

Arcadis IBI Group

Bay Area Rapid Transit (BART)

City of Charlotte, North Carolina

City of Portland, Oregon

Dallas Area Rapid Transit

David Evans and Associates, Inc.

DIALOG

**evolve environment::architect-
ure**

HDR

Hennepin County, Minnesota

**Hillsborough Area
Regional Transit Authority**

HNTB

InfraStrategies

Jacobs

Kimley-Horn

**Low Income Investment Fund
(LIIF)**

**Local Initiatives Support
Corporation (LISC)**

**Los Angeles County
Metropolitan Transportation
Authority (METRO)**

MARTA

Metropolitan Council

**Metropolitan Transportation
Commission**

Mobilify SWPA

Mott MacDonald

Nelson\Nygaard

Oregon Metro

Parametrix

Perkins&Will

Pittsburgh Regional Transit

**Pottstown Area Health and
Wellness Foundation**

**Regional Transportation
District (RTD)**

SEPTA

Sound Transit

TriMet

Trinity Metro

Valley Metro

VIA Metropolitan Transit

Vicus Planning

WSP

About Mpact: Mobility, Community, Possibility

At Mpact, when we look around the places people live, work, and play, we see something hidden in plain sight: possibilities.

We connect and support a network of leaders, practitioners and advocates who are dedicated engaging with communities to define what's possible and share practical, proven ways to get there. We foster "equitable transit-oriented communities" as the best way to address the climate crisis and create resilient and just places to live - for everyone.

We offer:

- **Mpact Transit + Community**, the annual conference that brings great thinking together about every aspect of transit, connected mobility options, land use and community development.
- **Mpact:LAB**, capacity building and leadership development in communities large and small. Find out about MOVE Roundtables: a short-term program in which key stakeholders examine a local question through the lenses of Mobility, Opportunity, Voice and Equity, creating shared goals and momentum.
- **Mpact:VOICES**, ways to connect year round. Subscribe to the Mpact Podcast to hear from a range of voices about what it takes to build great places to live.

Keep up with the latest at www.mpactmobility.org and via social media @mpactmobility.

Board of Directors

Board President: Diana, Mendes, Corporate President, Infrastructure and Mobility Equity, HNTB, Arlington, VA

Kelly Betteridge, Investment Areas Manager, Oregon Metro, Portland, OR *National Steering Committee Board Liaison*

Earl Blumenauer, Congressman, 3rd District, Oregon, Portland, OR

Flora Castillo, President, Pivot Strategies, LLC, Newark, NJ

Grace Crunican, Owner/Principal, Crunican LLC, Beaverton, OR

Tiffany Gunter, Deputy General Manager, SMART, Detroit, MI

Joe Horiye, Western Region Vice President, Local Initiatives Support Corporation (LISC), San Diego, CA

Taiwo Jaiyeoba, City Manager, City of Greensboro, Greensboro, NC

Nadine Lee, President and Chief Executive Officer, Dallas Area Rapid Transit (DART), Dallas, TX

Adelee LeGrand, Strategic Advisor, Intellectual Concepts, LLC., Atlanta, GA

Daniel Nissenbaum, Chief Executive Officer, Low Income Investment Fund (LIIF), New York, NY

Paul Skoutelas, President and Chief Executive Officer, American Public Transportation Association (APTA), Washington, DC

Scot Spencer, Associate Director for Advocacy and Influence, Annie E Casey Foundation, Baltimore, MD

**Mpact
Champions**

HNTB

NTI
National Transit Institute

WSP